

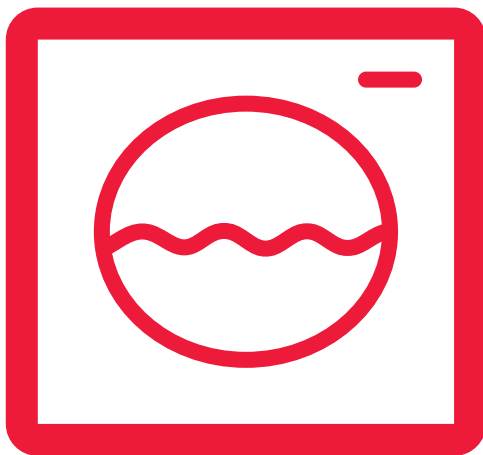

Washer/Dryer

EN

User Manual







Washer/Dryer

ES-HDD1047A0-EN

Thank you for choosing this product.

This User Manual contains important safety information and instructions on the operation and maintenance of your appliance.
Please take the time to read this User Manual before using your appliance and keep this book for future reference.

Icon	Type	Meaning
	WARNING	Risk of serious injury or death
	RISK OF ELECTRIC SHOCK	Dangerous voltage risk
	FIRE	Fire risk
	CAUTION	Injury or property damage risk
	IMPORTANT / NOTE	Information on operating the system correctly

CONTENTS

1.SAFETY INSTRUCTIONS	1
1.1. General Safety Warnings	2
1.2. During Use	7
1.3. Packaging and Environment.....	8
1.4. Savings Information.....	8
2.TECHNICAL SPECIFICATIONS.....	10
3.OVERVIEW OF YOUR MACHINE	11
3.1. General Appearance.....	11
4.SETTING UP THE MACHINE	11
4.1. Remove the Transit Bolts	11
4.2. Placing the Machine and Adjusting the Feet	12
4.3. Electrical Connection.....	12
4.4. Water Inlet Connection	13
4.5. Water Draining Connection	13
5.CONTROL PANEL OVERVIEW.....	14
5.1. Detergent Drawer General View.....	14
5.2. Sections	15
5.3. Program Dial.....	15
6.ADJUSTING MACHINE SETTINGS	15
6.1. Language Selection Setting	15
6.2. Eco Time Setting	16
6.3. Current Time Setting.....	17
6.4. Sound Adjustment	17
6.5. Screen Brightness Setting	17
6.6. Screen Contrast Setting	17
6.7. Revert to Factory Settings	18
7.WASHING OPERATION	18
7.1. Sorting Laundry	18
7.2. Explanation of Washing Symbols	19
7.3. Placing Laundry Into the Machine	19
7.4. Choice of Detergent and Placing Into the Machine	20
7.5. Programme Selection.....	21
8.Drying Your Washing	21
8.1. Cupboard Dry	21
8.2. Hanger Dry	21
8.3. Iron Dry	22
8.4. Drying With Duration	22
9.Additional Functions.....	22
9.1. Pre-wash Additional Function	22
9.2. Extra Rinse Function	23
9.3. Anti-Allergic Additional Function	23
9.4. Easy Ironing Additional Function	23

9.5. Economic Time Interval Additional Function	23
9.6. Delay Time / Finish Time Adjustment Additional Function	24
9.7. Memory Record Function (MEMORY).....	24
9.8. Start/Pause Button / Starting the Programme	26
9.9. Pausing a Programme / Adding Laundry	27
9.10. Child Lock	27
10.PROGRAMME TABLE.....	29
11.SELECTING SUB-PROGRAMMES	34
11.1. Synthetics	34
11.2. Delicates	34
11.3. Extras	35
12.MAINTENANCE AND CLEANING OF YOUR MACHINE	36
12.1. Warning	36
12.2. Water Inlet Filters	36
12.3. Detergent Drawer	36
12.4. Pump Filter	37
13.FLUSH STOPPER / BODY / DRUM	38
14.TROUBLESHOOTING	39
15.AUTOMATIC FAULT WARNINGS AND WHAT NEEDS TO BE DONE	41
16.DESCRIBING THE ENERGY LABEL AND SAVING ENERGY	42

1. SAFETY INSTRUCTIONS

Operating voltage / frequency	(V/Hz) (220-240) V~/50Hz
Total current (A)	10
Water pressure (Mpa)	Maximum 1 Mpa / Minimum 0.1Mpa
Total power (W)	2200
Maximum washing capacity (dry laundry) (kg)	10.0
Maximum drying capacity (kg)	6.0

- Do not install your machine on a carpet or such grounds that would prevent the ventilation of its base.
- The appliance is not intended for use by people (including children) with reduced physical, sensory or mental capabilities, or lack of experience and knowledge unless they have been given supervision or instruction concerning use of the appliance by a person responsible for their safety.
- Children of less than 3 years should be kept away unless continuously supervised.
- Call the nearest authorized service centre for a replacement if the power cord malfunctions.
- Use only the new water inlet hose coming with your machine when making water inlet connections to your machine. Never use old, used or damaged water inlet hoses.
- Children should not play with the appliance. Cleaning and user maintenance should not be made by children without supervision.

 **NOTE:** For softcopy of this user manual, please contact following address: “washingmachine@standardtest.info”. In your e-mail, please provide the model name and serial number (20 digits) which you can find on the appliance door.

To ensure your safety and the safety of others, please read the following safety precautions before using or installing your Washer Dryer.

Your machine is for domestic use only. Using it for commercial purposes will void your warranty.



1.1. General Safety Warnings

Before setting up your Washer Dryer, remove the four transit bolts and the rubber washers from the rear of the machine.

- Your warranty does not cover damage caused by external factors such as fire, flooding and other sources of damage.
- Retain this user manual for future use and pass it on to the next user.
- The necessary ambient temperature for operation of your Washer Dryer is 15-25 °C.
- Where the temperature is below 0 °C, hoses may split or the electronic card may not operate correctly.
- Please ensure that garments loaded into your Washer Dryer are free from foreign objects such as nails, needles, lighters and coins.
- Lints must not be allowed to accumulate around the washer dryer.
- Residue may build up on detergent and softeners exposed to air for a long period of time. Only put

softener or detergent in the drawer at the beginning of each wash.

- Unplug your Washer Dryer and switch off the water supply if the Washer Dryer is left unused for a long time. We also recommend that you leave the door open to prevent build up of humidity inside the Washer Dryer.
- Some water may be left in your Washer Dryer as a result of quality checks during production. This will not affect the operation of your Washer Dryer.
- Keep the document bag that was supplied inside your Washer Dryer and contained this user manual out of the reach of children and babies to prevent the risk of suffocation.
- The packaging of the machine could be hazardous to children. Do not allow children to play with the packaging or small parts from the Washer Dryer.
- Only use pre-wash programmes for very dirty laundry.
- Do not exceed the maximum load for the washing or drying programme you have chosen.
- In the event of a fault, unplug your Washer Dryer and switch off the water supply. Do not attempt to repair your Washer Dryer yourself. Repairs should only be undertaken by an approved service agent.
- Never open the detergent drawer while your Washer Dryer is running.
- Never force the door open when your Washer Dryer is running.
- Please follow the manufacturers' instructions on the use of fabric conditioner or any similar products that you intend to use in your Washer Dryer.
- Do not stop your Washer Dryer before the drying phase of a programme has been completed. If you

have to do so, quickly remove all of your laundry and immediately spread the items on an appropriate surface to allow them to cool.

- The appliance must not be supplied through an external switching device, such as a timer, or connected to a circuit that is regularly switched on and off by a utility.
- This appliance must not be installed behind a lockable door, a sliding door or a door with a hinge on the opposite side to that of the washer dryer, in such a way that a full opening of the washer dryer door is restricted.
- Install your Washer Dryer in a location that can be ventilated and has constant air circulation.

SAFETY WARNINGS

- You must read these warnings. Ignoring these warnings may put you or others at risk of fatal injuries.

RISK OF BURNS

- Do not touch the door, drain hose or any discharged water while your Washer Dryer is running. The high temperatures involved pose a burn risk.
- Open the door fully after the drying process. Do not touch the door glass. It will reach high temperatures and pose a burn risk.

ELECTROCUTION RISK

Do not connect your Washer Dryer to the mains electricity supply using an extension lead.

- A damaged power cord/plug can cause fire or give you an electric shock. When damaged it must be replaced, this should only be done by qualified personnel.

- Never remove the plug from the socket by pulling the cord. Always hold the plug.
- Never touch the power cord/plug with wet hands as this could cause a short circuit or electric shock.
- Do not touch your Washer Dryer if your hands or feet are wet.
- Call the nearest authorised service company for assistance if the power cord malfunctions.

Explosion Risk

- Thoroughly rinse off any chemicals, such as stain remover, from your garments before beginning a washing and drying programme. Failure to do so may cause a risk of explosion when the drying function is used.

Fire Risk

- Do not keep flammable or explosive liquids near your machine.
- Items that have been soiled with substances such as cooking oil, acetone, alcohol, petrol, kerosene, spot removers, turpentine, waxes and wax removers should be washed in hot water with an extra amount of detergent before being dried in the tumble dryer.
- Do not use a detergent ball/device if you have selected a washing and drying programme as this may cause a fire hazard.
- Do not dry your laundry under the conditions specified below as they present a fire risk.
 - If the laundry is not washed.
 - If oil based stains are not pre-treated before beginning a washing or drying programme.
 - Laundry which has been cleaned with industrial chemicals.



- Laundry that has a high amount of sponge, foam, rubber or rubber-like parts and accessories.
- Items such as foam rubber (latex foam), shower caps, waterproof textiles, rubber backed articles and clothes or pillows fitted with foam rubber pads should not be dried in the drying process of the appliance.
- Stuffed or damaged items (such as pillows or jackets). The rubber sponge presents a fire risk during the drying process.
- Never use products that contain solvents in your machine.
- Please ensure that garments loaded into your Washer Dryer are free from foreign objects such as nails, needles, lighters, matches and coins.

Fall and Injury Risk

- Do not climb on your Washer Dryer.
- Make sure hoses and cables do not cause a trip hazard.
- Do not turn your Washer Dryer upside down or on its side.
- Do not lift your Washer Dryer using the door or detergent drawer.
- Make sure hoses and cables do not cause a trip hazard.

 **To avoid risk of injury, please take care when moving your Washer Dryer. It is heavy and we recommend that a minimum of two people move your Washer Dryer.**

Child Safety

- Do not allow children to play with the machine.
- Do not leave children unattended near the machine.

They might lock themselves in the machine.

- The door glass and machine surface can become extremely hot during operation. Do not allow children to touch the machine; it may damage their skin.
- The packaging of the machine could be hazardous to children. Do not allow children to play with the packaging or small parts from the Washer Dryer.
- Poisoning and irritation may occur if detergent or other washing aids are consumed or come into contact with skin or eyes. Keep cleaning materials out of reach of children.

1.2. During Use

- Do not allow pets near the machine.
- Please ensure that you have removed all of the packaging materials and protective tape from the outside of your Washer Dryer, inside the drum and inside the detergent drawer before using. Check for any external visible damage. Do not install or use your Washer Dryer if it is damaged.
- Your Washer Dryer is for domestic use only and is only intended to wash and dry items which are specified by the manufacturer to be machine washable and dryable on the label and textiles composed of hand washable wool or wool blend fabrics as well as satin, lace, silk and other hand-washable garments. Do not use your Washer Dryer for any purpose not expressly specified in this user guide.
- This appliance can be used by children aged from 8 years and above and by persons with reduced physical, sensory or mental capabilities or lack of experience and knowledge if they have been given

supervision or instruction concerning use of the appliance in a safe way and understand the hazards involved. Children shall not play with the appliance. Cleaning and user maintenance shall not be done by children without supervision.

- Installation of your machine must only be carried out by an authorised service agent. Installation by anyone other than an authorised agent will void your warranty.

1.3. Packaging and Environment

DISPOSE OF PACKAGING AND YOUR OLD MACHINE RESPONSIBLY

Removal of packaging materials

Packaging materials protect your machine from any damage that may occur during transportation. Please recycle the packaging materials.

Recycled material reduces raw material consumption and lowers waste production.

1.4. Savings Information

Some important information to get the most efficient use out of your machine:

- The amount of laundry you put in your Washer Dryer should not exceed the maximum amount indicated. Avoid overloading to allow your machine to run more efficiently.
- Not using the pre-wash feature for normal and lightly soiled laundry will save electricity and water consumption.

We declare that our products meet the applicable European Directives, Decisions and Regulations and the requirements listed in the standards referenced.



Disposal of your old machine



The symbol on the product or on its packaging indicates that this product may not be treated as household waste. Instead it shall be handed over to the applicable collection point for the recycling of electrical and electronic equipment. By ensuring this product is disposed of correctly, you will help prevent potential negative consequences for the environment and human health, which could otherwise be caused by inappropriate waste handling of this product. For more detailed information about recycling of this product,

please contact your local city office, your household waste disposal service or the shop where you purchased the product.

2. TECHNICAL SPECIFICATIONS

Maximum washing capacity (dry laundry) (kg)	10.0
* Maximum drying capacity (kg)	6.0
Spin speed (rpm)	1400
Number of programmes	15
Operation voltage / Frequency (v/hz)	220-240 / 50
Water pressure (mpa)	Maximum: 1 Minimum: 0.1
Dimensions (HxWxD) (mm)	845x597x582
* Do not dry laundry if it is not wet as this is a fire risk.	
Energy consumption (washing, spinning, drying) (kWh/cycle)	6.80
Energy consumption (washing and spinning only) (kWh/cycle)	1,28
Water consumption (washing, spinning, drying) (L/cycle)	155
Water consumption (washing and spinning only) (L/cycle)	65
Control programs in accordance with EN 50229 standard	
Program used for the washing cycle :	
Program: Cotton Eco, Load: 10 kg, Temperature: 60°C, Spin Speed: Max – 1400 rpm, Option: No option selected.	
Programs used for the drying cycle:	
Drying of the 1st part:	
Program : “cotton dry”, load: ~Load group 6 kg (with a load group including 2 sheet - 8 pillowcases - 23 towels) Option: Cupboard Dry: ()	
Drying of the 2nd part:	
Program : “cotton dry”, load: ~load group 4 kg (with a load group including 2 sheet - 8 pillowcases - 4 towel) Option: Cupboard Dry: ()	

3. OVERVIEW OF YOUR MACHINE

3.1. General Appearance

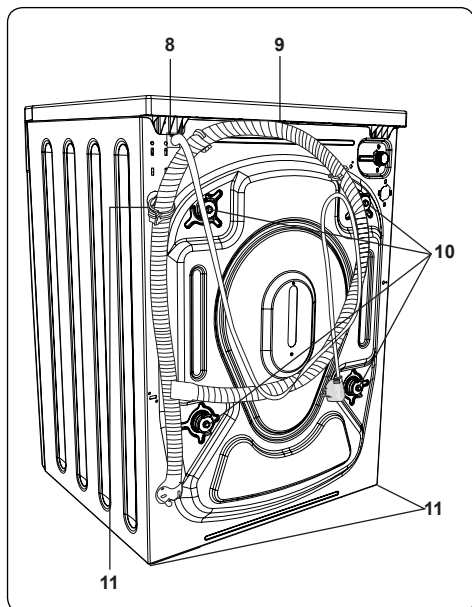
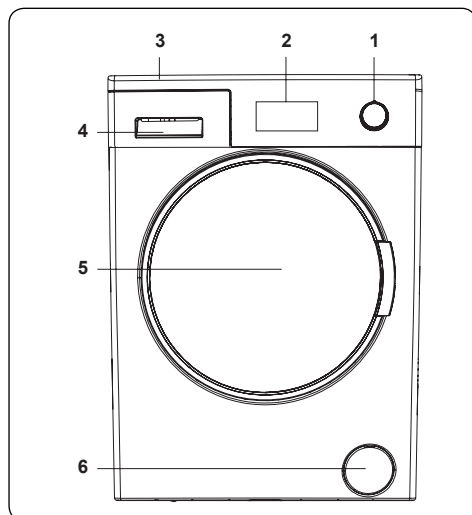

1. Programme Button
2. High-resolution LCD display
3. Upper Tray
4. Detergent Drawer
5. Door

6. Pump Filter Cover
7. Power Cord
8. Drain Hose
9. Transport screws
10. Adjustable Feet
11. Plastic Drain Hose Holder: (Do not remove the holder; the operation of the machine will be affected).

4. SETTING UP THE MACHINE

Your machine must only be installed by an authorised service company.

4.1. Remove the Transit Bolts

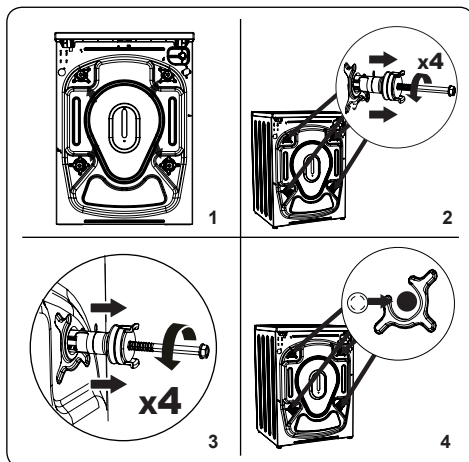

1. Before operating your machine, you must remove the transit bolts from the rear of the machine.
2. Loosen the transit bolts by rotating them anticlockwise with an appropriate spanner.
3. The transit bolts can then be removed with a straight pull. The removed transit bolts should be stored in case you need to transport your Washer Dryer in the future.



NOTE: You must remove the transit bolts from your machine before first use. Faults occurring in machines operated with transit bolts still fitted are out of the scope of the warranty. Fit the plastic blanking caps supplied in the accessories bag into the gaps left by the removal of the transport bolts. The transport screws should be stored for future use.

4. Insert the plastic blanking caps from the accessories bag into the gaps left by the transit bolts.

4.2. Placing the Machine and Adjusting the Feet

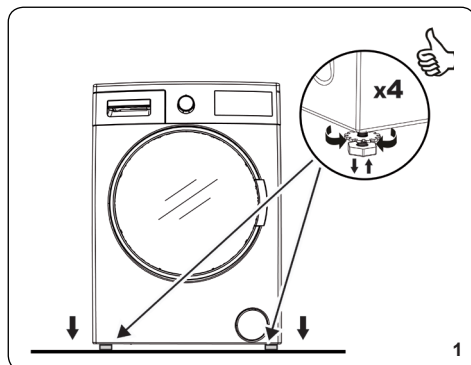

1. Do not install your machine on a carpet or surface that will block ventilation at the base.
2. To ensure silent and vibration-free operation of your machine, install it on a firm surface.

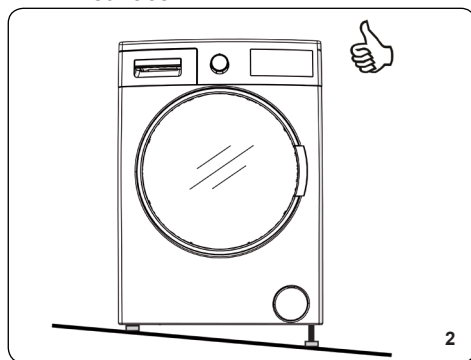

3. You can adjust the level of your machine by using the gauge at the top.

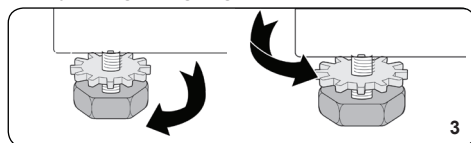

4. You can level your Washer Dryer by using the adjustable feet:
 - Loosen the plastic adjustment nut.
 - Turn the feet clockwise to increase the height of the machine. Turn the feet anti-clockwise to decrease the height of the

machine.

- Once the machine is level, tighten the plastic adjustment nut.

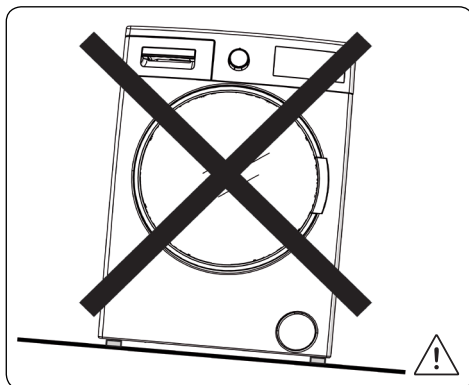

- Never insert cardboard, wood or other similar materials under the machine to level it.
- When cleaning the ground on which the machine is located, take care not to disturb the level of the machine.

4.3. Electrical Connection

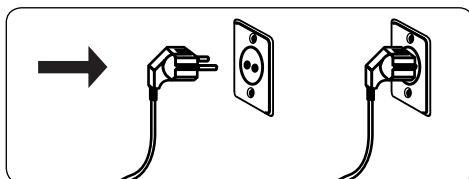

- Your Washing Machine requires a 220-240V, 50Hz mains supply.
- The mains cord of your washing machine is equipped with an earthed plug. This plug should always be inserted to an earthed socket of 10 amps.
- The plug should always be inserted to a grounded socket of 10 amperes. The fuse rating of the plug should also be 10 amperes.
- If you do not have a suitable socket and fuse conforming with this, please ensure the work is carried out by a qualified electrician.
- We do not take responsibility for damage that occurs due to the use of ungrounded equipment.



NOTE: Operating your machine with low voltage will cause the life cycle of your machine to be reduced and its performance to be restricted.

4.4. Water Inlet Connection

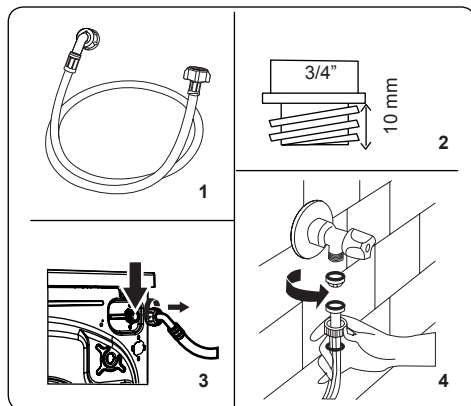

- Operate your Washer Dryer with cold water only.
- Only use the water inlet hose supplied with your machine or one purchased through an authorised dealer.
- A gasket is included in the hose packaging to prevent water leaks from connections. Fit this gasket to the end of the water inlet hose that will be connected to the tap.
- Connect the angled end of the water inlet hose to the cold water inlet on the rear of the machine and hand-tighten.
- Screw the other end of the water inlet hose onto a 3/4" water tap and hand-tighten.

- If in any doubt, consult a qualified plumber.
- Turn the cold water supply on and check for any leaks.
- Water flow with pressure of 0.1-1 Mpa will allow your machine to operate at optimum efficiency (pressure of 0.1 Mpa means that more than 8 litres of water per minute will flow through a fully opened tap).
- Ensure that the hose is not trapped, kinked, twisted, folded or crushed.



NOTE: Only use the water inlet hose supplied with your machine when making connections. Never use old, used or damaged water inlet hoses.

4.5. Water Draining Connection

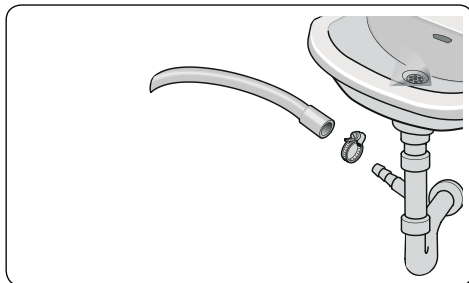

- Connect the water drain hose to a standpipe or to the outlet elbow of a household sink, using additional equipment. The hose must be placed between 0 cm and 80 cm from the ground.
- Never attempt to extend the water drain hose.
- Do not put the water drain hose from

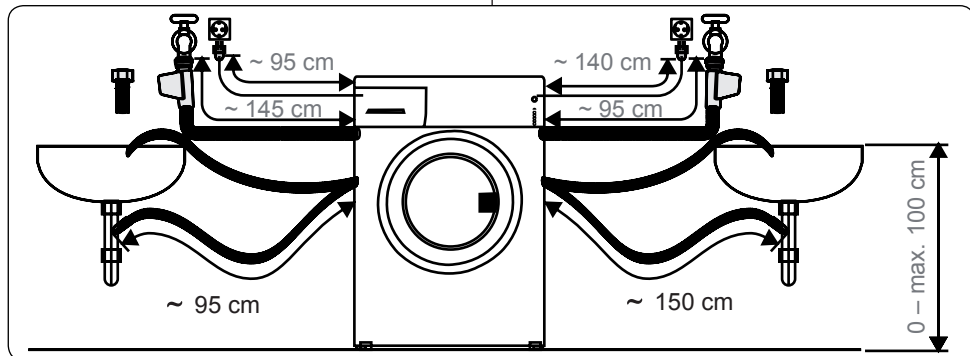

your machine into a container, bucket or bathtub.

- Make sure that the water drain hose is not bent, buckled, crushed or extended.

5. CONTROL PANEL OVERVIEW

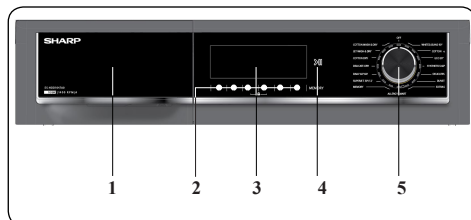

- 1. Detergent drawer**
- 2. Adjustment and additional function buttons:** The buttons on your machine are touch buttons. You only have to touch them lightly to make a selection.
- 3. Info Screen:** Displays details of the selected programme and information on the status of your machine.
- 4. Start/Pause button:** Start or Pause the selected programme.
- 5. Programme Dial:** Turn the programme dial clockwise or anticlockwise to select the required programme. Make sure that the dial is pointing exactly at the selected program.

5.1. Detergent Drawer General View

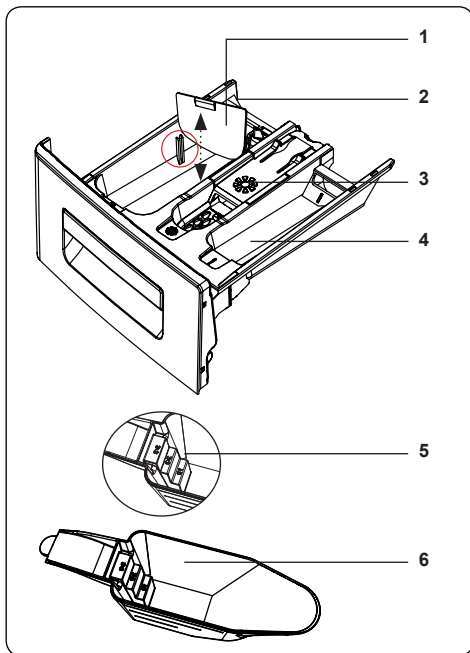
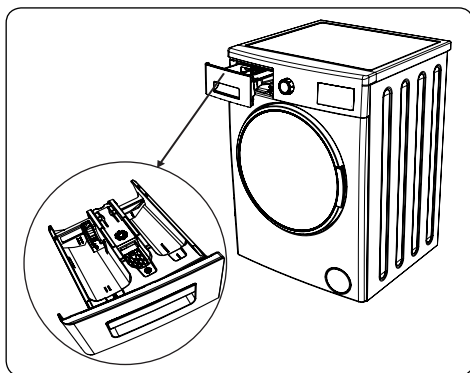

1. Liquid Detergent Attachments
2. Main Wash Detergent Compartment
3. Softener Compartment
4. Pre-Wash Detergent Compartment
5. Powder Detergent Levels
6. Powder Detergent Scoop (*)

(*) Specifications may vary depending on the machine purchased.

5.2. Sections

Main wash detergent compartment:

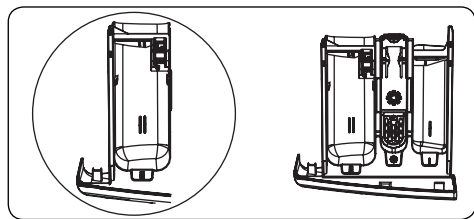

This compartment is for liquid or powder detergents or limescale remover. The fluid detergent level plate will be supplied inside your machine. (*)

(*) Specifications may vary depending on the machine purchased.

Fabric conditioner, starch, detergent compartment:

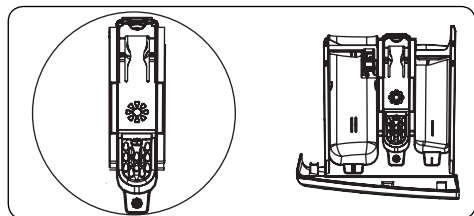

This compartment is for softeners, conditioners or starch. Follow the instructions on the packaging. If softeners leave residue after use, try diluting or using a liquid softener.

Pre-wash detergent compartment:

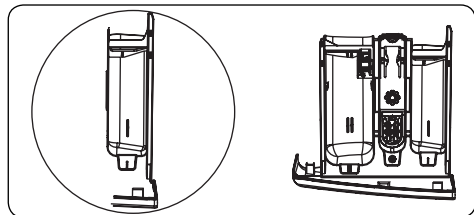

This compartment should be used only when the pre-wash feature is selected. We recommend that the pre-wash feature is used only for very dirty laundry.

5.3. Program Dial

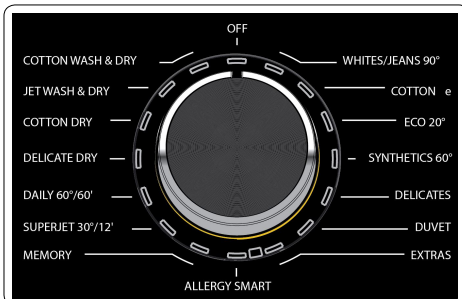

- To select the desired programme, turn the programme dial either clockwise or anti-clockwise until the marker on the programme dial points to the chosen programme.

6. ADJUSTING MACHINE SETTINGS

Before using your Washer Dryer for the first time:

- Plug in your machine.
- Open the water tap.
- Turn the programme dial.

6.1. Language Selection Setting

- When setting the language for the first time 'Select Language' will appear on the information screen.

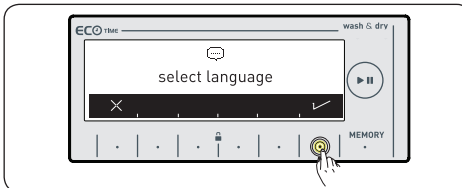

- To change the current language setting press the ✓ button.
- To exit the language selection screen without making a selection, press the X button.

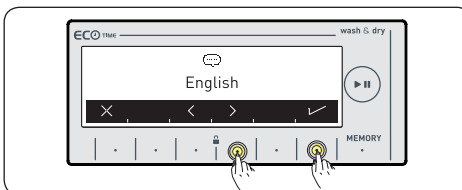

- Select the required language by pressing the <> buttons until the correct language is displayed.
- To confirm the language selection press the ✓ button.



- To change the language selection again, press the [X] button to open the settings menu and select the language selection page. Then use the <> buttons to select the required language.

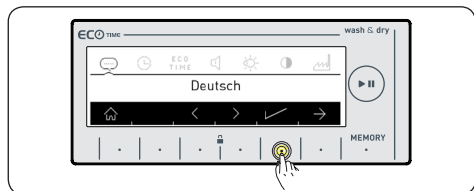

- Press the ✓ button to save the language you selected.
- You will be asked to confirm the language selection on screen.

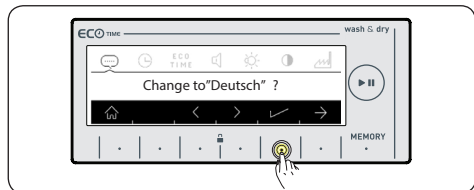

- Press the ✓ button again to confirm the selection.
- If you believe you have selected the wrong language, press the X button to cancel the selection and make another choice.
- When you confirm the language change, the language you have selected will be active.

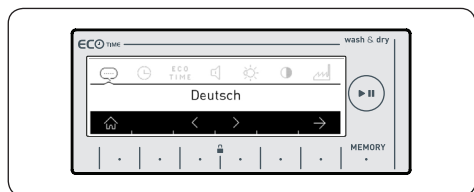

6.2. Eco Time Setting ECO TIME (Economic Time Interval)

- Your Washer Dryer contains an Eco Time Setting option which allows you to set your Washer Dryer to run during the hours when your electricity tariff is more economical. Refer to your electricity provider to find the electricity tariffs and times.



NOTE: A smart counter will be required in order for this mode to work.

- Press the ✓ button to set the Eco Time option.
- To set the Eco Time option later, press the X button.

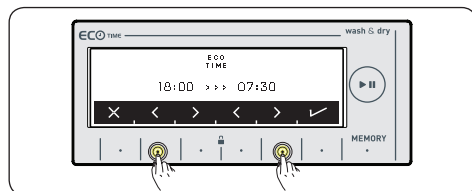
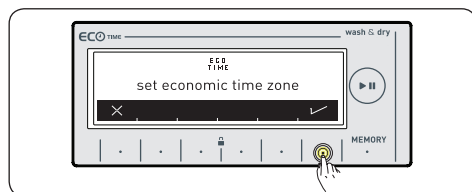

- Use the <> buttons to set the start and end times for the Eco Time interval. See page 21 to activate the Eco Time interval additional function.

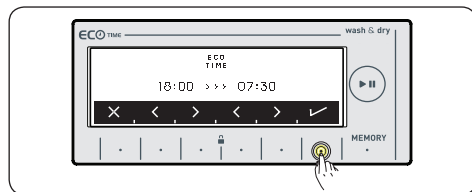

- Press the ✓ button to confirm the Eco Time interval.

6.3. Current Time Setting

- We recommend that you set the correct time during the initial set-up of your Washer Dryer.

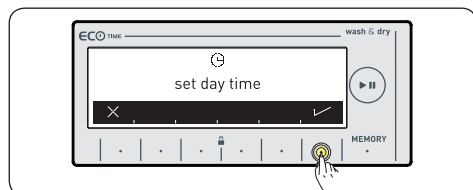

- Your machine will ask you to set the current time. Press the ✓ button to open the Set Time menu or the X button to exit without setting the time.



NOTE: We strongly recommend that you set the current time accurately as other operating features depend on it.



NOTE: Time setting information will be lost if you leave your Washer Dryer unplugged for more than 15 days. In this case you will be prompted to set the time when you next turn your Washer Dryer on.

- Use the >> buttons to set the correct hours and minutes.

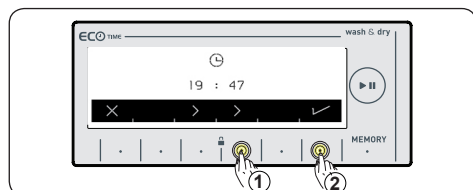

- Press the ✓ button to confirm the time.

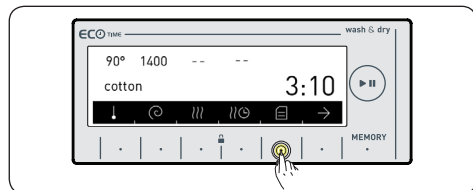

- When you have confirmed the time setting, your machine will automatically go to the main screen of the programme you have selected. To make further changes to your settings, press the ≡ button and select the setting you want to change.

6.4. Sound Adjustment

- You can switch the warning sounds of your Washer Dryer on or off. Use the <> buttons to switch between the options below.

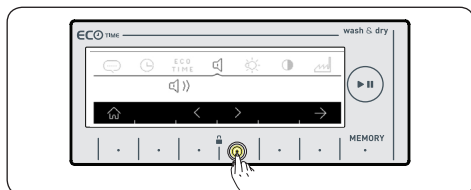

- The speaker icon indicates that warning sounds are switched on.

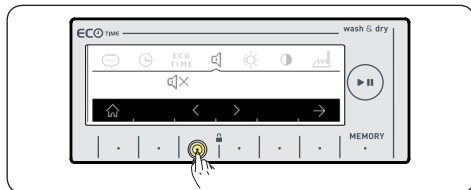

- The speaker icon with an X indicates that warning sounds are switched off.

6.5. Screen Brightness Setting

- You can adjust the brightness setting of the information screen on your Washer Dryer. Use the <> buttons to adjust the brightness.

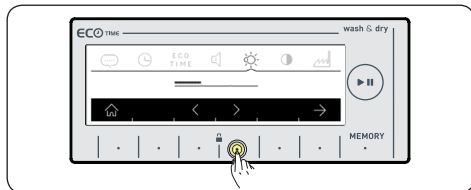

- Press the → button to move to the contrast settings option.

6.6. Screen Contrast Setting

- You can adjust the contrast of the information screen on your Washer Dryer. Use the <> buttons to adjust the contrast.

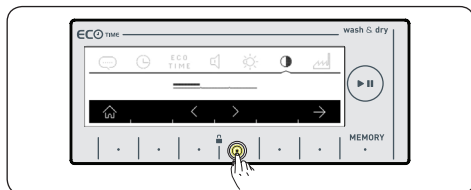

- Press the → button to move to the revert to factory settings option.

6.7. Revert to Factory Settings

To reset your Washer Dryer to the factory default settings:

- Press the ↺ symbol.

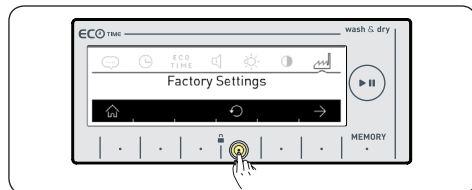

- You will be asked to confirm that you want to reset your Washer Dryer to Factory Settings.



- Press the ✓ button to confirm the reset.
- To cancel the reset press the ✕ button.
- You can return to the main screen at any time by pressing the 🏠 button.

7. WASHING OPERATION

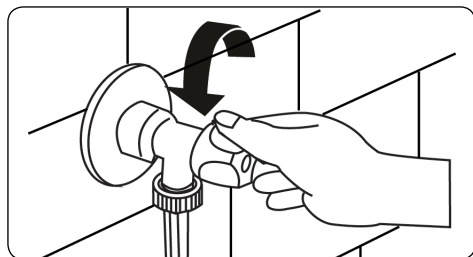

- Turn on the water supply.

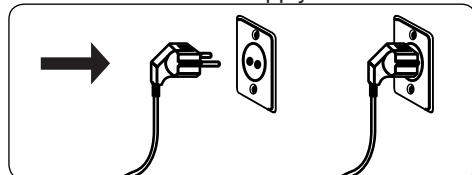

- Plug in your machine

7.1. Sorting Laundry

 Your laundry contains product labels which specify the appropriate washing conditions. Wash or dry your laundry according to the specifications on the product label.





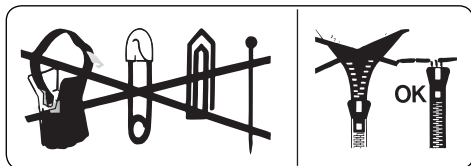











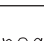



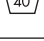

- Sort your laundry according to their type (cotton, synthetic, delicates, wool, etc.), washing temperature (cold, 30°C, 40°C, 60°C, 90°C) and the level of dirtiness (less dirty, dirty, very dirty).
- Never wash coloured and white laundry together.
- Dark textiles may contain excess dye and should be washed separately several times before being included in a mixed load.
- Ensure that there are no metallic materials on your laundry or in the pockets; if so, remove them.

 **WARNING:** Any malfunction occurring due to foreign materials damaging your machine are not covered by the warranty.

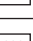

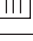



- Close zips and fasten any hooks and eyes.
- Remove the metallic or plastic hooks of curtains or place them in a washing net or bag.
- Reverse textiles such as pants, knitwear, t-shirts and sweat shirts.
- Wash socks, handkerchiefs and other small items in a washing net.

7.2. Explanation of Washing Symbols

	Machine wash		Maximum ironing temperature 110°C
	Machine wash, permanent press		Do not iron
	Maximum washing temperature 95°C		Can be dry cleaned with any solvents
	Maximum washing water temperature 60°C		Can only be cleaned with perchloride, lighter gas, alcohol or R113.
	Maximum washing water temperature 40°C		Can only be cleaned with perchloride, lighter gas, alcohol or R113.
	Maximum washing water temperature 30°C		Do not dry cleaning
	Hand wash		Dry flat
	Do not wash		Drip dry
	Can be bleached in cold water		Line dry
	Do not use bleach.		Tumble dry
	Maximum ironing temperature 200°C		Tumble dry high
	Maximum ironing temperature 150°C		Do not tumble dry

7.3. Placing Laundry Into the Machine

 Select a programme before loading laundry into your Washer Dryer. If you do not select a programme the load sensor will not be activated.

 **NOTE:** The maximum load capacity of your Washer Dryer may change according to the programme you have selected. If you exceed the load capacity of the selected programme a  symbol will be displayed on the information screen accompanied with a warning sound. If this occurs, we recommend that you remove items of laundry until the  symbol disappears.

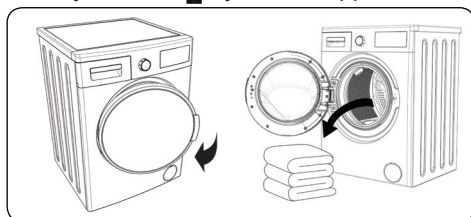

- Open the door using the handle.
- Check inside the drum. There might be laundry left inside from previous washes. If there is, empty your machine before selecting your programme.
- Place your laundry in the machine, spreading it well. Fold large objects such as quilts and blankets into the machine as shown below.

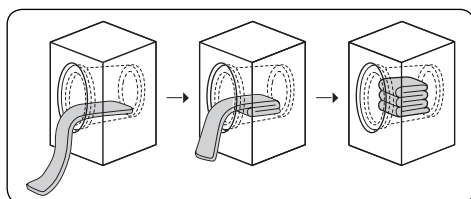

- Your Washer Dryer contains a load detection system. This load detection system measures the weight of the laundry inside your Washer Dryer and displays the increase in load on the information screen. Your Washer Dryer automatically adjusts programme features such as programme duration, energy consumption and water consumption according to the amount of washing in the drum.
- If you operate your Washer Dryer when it is overloaded, washing and

drying performances will be affected. Additionally, your Washer Dryer can be damaged and your clothes may become yellow after drying programs.

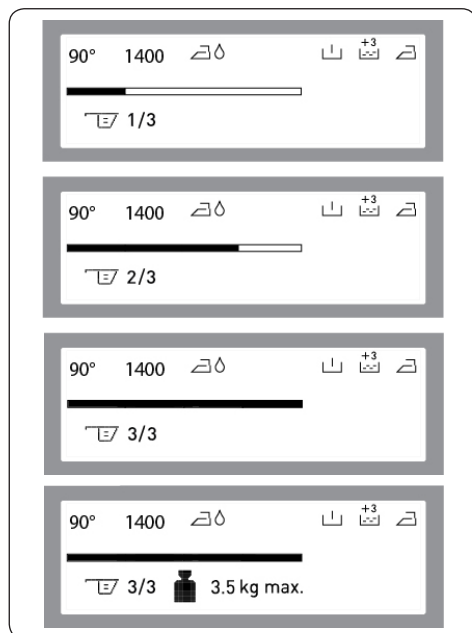

- Put each item of laundry into the machine separately.
- Ensure that no laundry is stuck between the cover and door seal when closing the door of your machine.
- Ensure that the machine door is completely closed.
- Tightly shut the door of your machine or the machine won't start the washing operation.

7.4. Choice of Detergent and Placing Into the Machine

The amount of detergent you require will depend on the following criteria:

- How soiled your laundry is.
- The hardness of the water.
- The amount of laundry to be washed.
- If your clothes are only slightly soiled, do not do a pre-wash and put a small amount of detergent (as specified by the manufacturer) into compartment 2 of the detergent drawer.

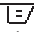
- If your clothes are excessively soiled, select a programme with a pre-wash and put $\frac{1}{4}$ of the detergent to be used into compartment 1 of the detergent drawer and the rest in compartment 2.
- Use detergents produced for automatic washing machines in your machine. Follow the instructions on the detergent packaging when determining the amount of detergent to use for your laundry.
- Put the softener in the softener compartment in the detergent drawer. Do not exceed the MAX level, otherwise softener will flow into the washing water through flushing.
- Softeners with high density must be thinned before being put in the drawer. High-density softener will clog the flush and block the flow of the softener.
- You can use liquid detergent in all programs without a prewash. To do this, slide the fluid detergent level plate into the guides in compartment 2 of the detergent drawer and adjust the liquid detergent amount (follow the instructions on the liquid detergent packaging). Do not fill the liquid detergent above the MAX level. Only use the fluid detergent level plate for liquid detergent, remove the plate if you are using powder detergent.
- Your machine displays a  symbol and indicates how much detergent is required based on the weight of your laundry.

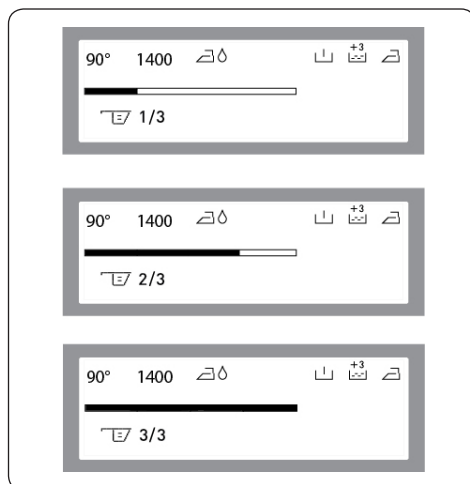



NOTE: 3/3 indicates a completely full detergent drawer. Place the correct amount of detergent (as indicated on the screen) in your washing machine.

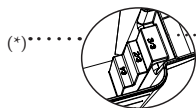

Powder detergent level steps



Do not use a detergent dosage adjustment device/ball if you have selected a programme with a drying function as this could pose a fire risk.

7.5. Programme Selection

To select the desired programme, turn the programme dial either clockwise or anti-clockwise until the marker on the programme dial points to the chosen programme.

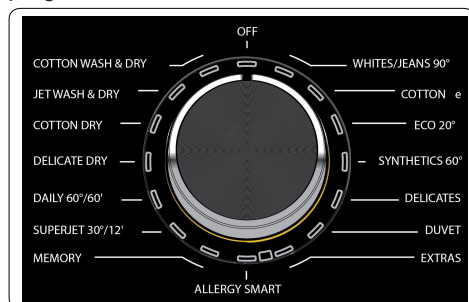

The programme name and features will be displayed on the screen.



- You can adjust the temperature (✱, 20°, 30°, 40°, 60°, 90°) by pressing the ↓ button.
- You can adjust the spin speed (⌚, 400, 600, 800, 1000, 1200, 1400) by pressing the ⌚ button.



NOTE: If you select a drying programme after setting the spin

speed, your machine will set the spin speed automatically to enhance drying performance,

- Refer to page (27-31) of the programme table for programme features.

8. Drying Your Washing

If you would like your laundry dried at the end of a washing programme, select the required drying setting by pressing the ||| button.

8.1. Cupboard Dry

- Recommended for laundry that you will put directly in a cupboard after taking it out of your Washer Dryer.
- To select the Cupboard Dry setting, press the ||| button until the symbol is displayed on the screen.



NOTE: If the symbol is not displayed when you press the ||| button, it means that this setting is not available for the selected washing programme.

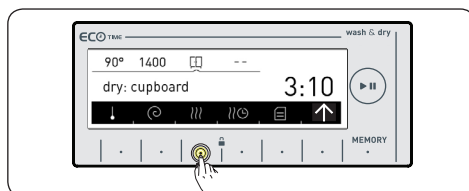

8.2. Hanger Dry

- Recommended for laundry that requires hanger drying.
- To select the Hanger Dry setting, press the ||| button until the symbol is displayed on the screen.



NOTE: If the symbol is not displayed when you press the ||| button, it means that this setting is not available for the selected washing programme.

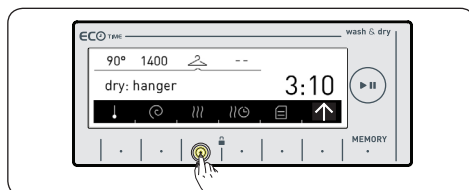

8.3. Iron Dry

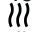
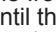
- Recommended for laundry that you will iron after washing and drying.
- To select the Iron Dry setting, press the  button until the  symbol is displayed on the screen.

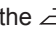
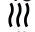

NOTE: If the  symbol is not displayed when you press the  button, it means that this setting is not available for the selected washing programme.

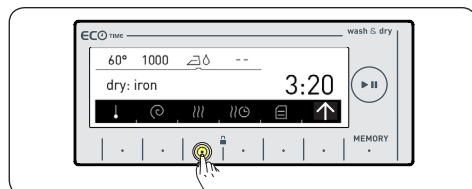

8.4. Drying With Duration

To set the duration of a drying programme:

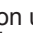
- Press the  button until the desired drying time is displayed.
- Drying selections will be displayed on your machine screen as 30, 60 and 120 minutes.



NOTE: If one of the 30min 60min 120min symbols is not displayed on the screen when you select the duration drying setting, it means that this setting is not available for the selected washing programme or the load in the machine.

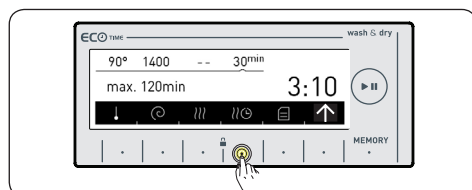

Duration Drying Programmes

Amount of laundry to dry	Recommended drying time
1 kg	30 minutes
2 kg	60 minutes
3.5 kg	120 minutes

If the amount of laundry to be dried is above 3.5kg, we recommend that you select Cupboard, Hanger or Iron Drying instead.

9. Additional Functions

Before starting the selected programme you have the option to select an additional function.

- Press the  button to view the available additional functions for the selected programme.
- Press the button of an additional function you would like to select.



NOTE: Not all additional functions are available for every programme. An additional function may not be available because:

- It is not compatible with another function you have already selected.
- There may not be enough time left on the current programme to carry out the additional function you want to select.
- Refer to the programme tables (in pages between 27-31) for a list of additional functions usable with programmes.

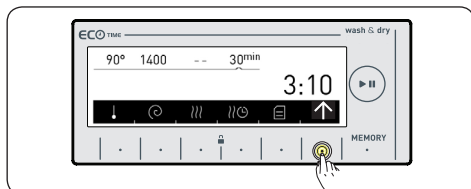

9.1. Pre-wash Additional Function

This allows you to give heavily soiled laundry a pre-wash before the main washing programme takes place. When using this function, you should put detergent in the front washing compartment of the detergent drawer.

- Press the  button to activate the pre-wash additional function.



NOTE: If the  symbol is not displayed on the screen when you want to choose the pre-wash additional function, it means that this function is not available for the selected washing programme.

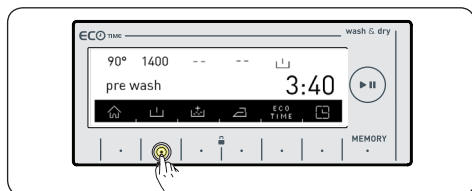

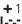
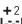
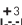

9.2. Extra Rinse Function

This allows you to add up to 3 additional rinses to the end of the selected wash programme.

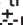
-  : Indicates that one additional rinse is made at the end of washing.
-  : Indicates that two additional rinses are made at the end of washing.
-  : Indicates that three additional rinses are made at the end of washing.

- To activate the extra-rinse function, press the  button until the symbol displaying the desired number of rinses is shown on the information screen.

 **NOTE:** If the  symbol is not displayed on the screen when you want to select the additional rinsing function, it means that this function is not available for the selected washing programme.

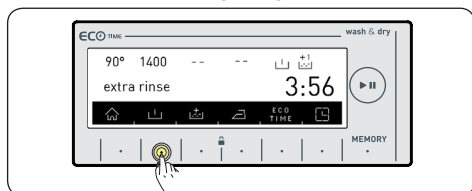

9.3. Anti-Allergic Additional Function

This additional rinse operation will carry out all rinsing steps in hot water. We recommend using this on laundry worn on delicate skin such as baby clothes or underwear.

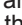
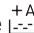

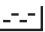
- To activate the anti-allergic additional function, press the  button until the  symbol is displayed on the information screen.

 **NOTE:** If the  symbol is not displayed on the screen when you want to select the anti-allergic additional function, it means that this function is not available for the selected washing programme.





9.4. Easy Ironing Additional Function

- Using this function will result in your laundry being less wrinkled at the end of the selected washing programme.
- To activate the easy ironing additional function, press the  button.

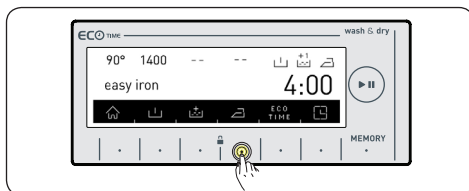
 **NOTE:** If the  symbol is not displayed on the screen when you want to select the easy ironing additional function, it means that this function is not available for the selected washing programme.



9.5. Economic Time Interval Additional Function

- Before activating this function please ensure that you have carried out the Eco Time Setting as described on page 14.
- To activate the Eco Time function press the  button.
- The  symbol is displayed on the screen.

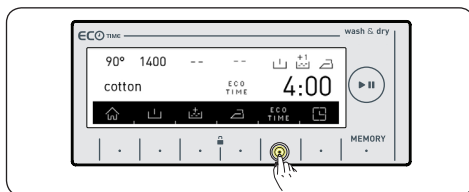

- The Eco Time feature will be displayed on the screen until Eco Time is switched off. To switch off Eco Time, press the  button.



- To run a program while the Eco Time feature is active, press the button. The start of the programme will be delayed until the start of the Eco Time interval. The programme start time and duration will be displayed alternately on the information screen.



- If you do not wish to run the selected programme between the Eco Time hours, press the button again. "eco time cancelled" will be displayed on the information screen.



- Your machine will return to the main screen of the programme you have selected in 3 seconds. To start the selected programme, press the Start/ Pause button.

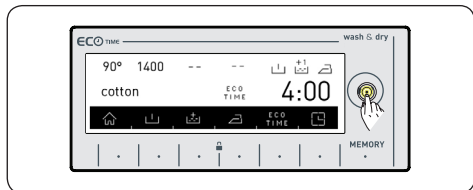

9.6. Delay Time / Finish Time Adjustment Additional Function

- This allows you to either delay the start time of the selected programme (from 10 minutes up to 23 hours 50 minutes) or specify the finish time of the programme.

- To activate the Delay Time/Finish Time function, press the button.

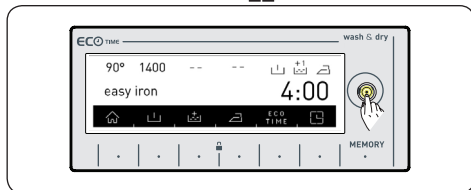

- The current time is briefly displayed on the screen.



- The delay time / finish time screen is displayed.
- You can increase or decrease the delay or finish time in 10 minute intervals by using the buttons.

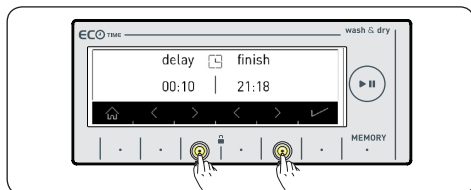

NOTE: The current time must be accurately set to be able to use this function correctly. See page 14 to change the current time setting.

9.7. Memory Record Function (MEMORY)

This feature allows you to store your preferred washing, drying and additional function settings so that you can easily use them again.

To use this function, select the washing machine settings that you wish to store and press the 'MEMORY' button.

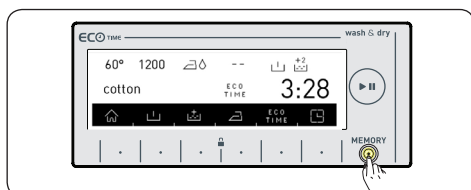

- If you would like to make changes to the washing and drying programme before storing, return to the programme menu by pressing the **X** button.



Make the required changes and press the 'MEMORY' button again.

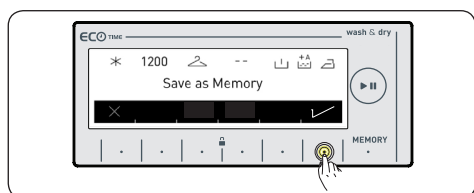
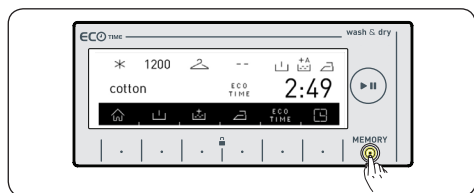

- Once you are happy with your chosen settings, press the **✓** button.

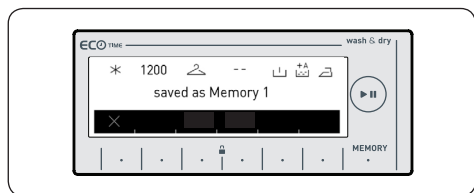

- 'Saved as memory' is displayed on the information screen and the machine will then return to the main programme screen.
- To start the saved washing programme, press the Start/Pause button, or select another programme.

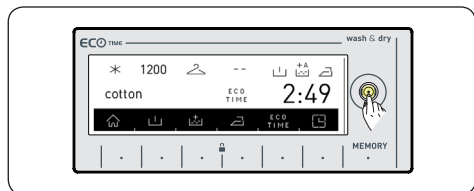

- To use the programme you have stored in the memory, turn the programme dial to Memory and press the Start/Pause button.

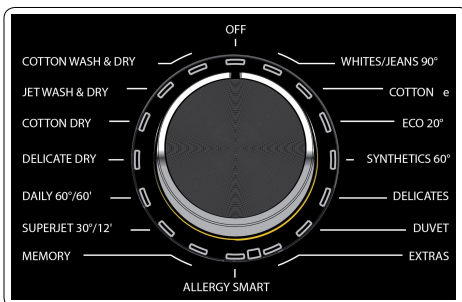

- To change the settings you have stored in the memory, select the memory option, or select the programme combination settings you want to save, and press the (MEMORY) button.

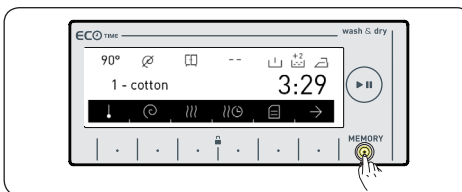

- If you are overwriting a previously stored programme, a confirmation message is displayed on the screen.
- You can confirm your selection by pressing the **✓** button.

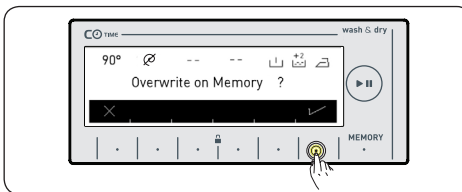

- 'Saved as memory' will be displayed to confirm that the new settings have been stored.



9.8. Start/Pause Button

Starting the Programme

- To start the selected programme, press the Start/Pause button.
- When you turn your machine on, the last programme you selected will be displayed on the screen. The screens below display examples of what is displayed on screen during washing operations.

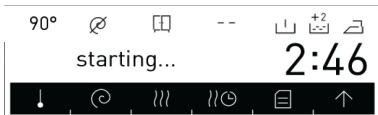

Washing programme is ready.

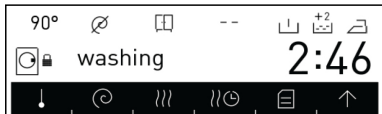

Washing programme is active.

Washing step

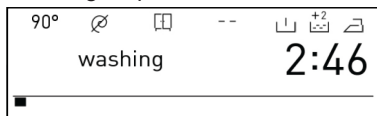

insing step.



Spinning step.

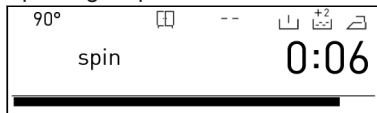

Drying programme ready.



Drying programme selected.

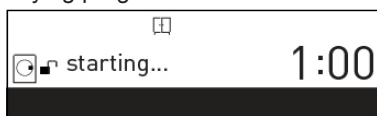

Drying programme active.



Drying step.



Programme end.

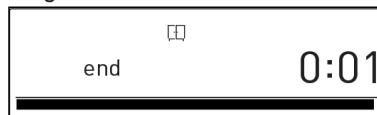

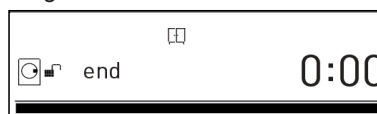

Programme end. Door unlocked.



9.9. Pausing a Programme / Adding Laundry



- If the  symbol is displayed on the screen, you can open the door of your machine and add laundry.
- If the  symbol is displayed on the screen your machine has progressed too far into the selected programme to add laundry.

Cancelling a Programme

- To cancel a running programme at any time:
- Turn the programme dial to the CANCEL position.
- Your machine will stop the current programme.
- Turn the programme dial to any other programme setting to drain the machine.
- Your machine will discharge any water in the machine and cancel the programme.
- You can now select and run a new programme.

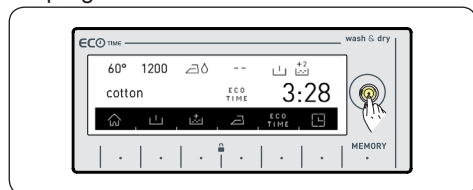

- See Page 27-31 for the Program Table

Ending a Programme

Your Washer Dryer will automatically stop when the programme you have selected finishes.

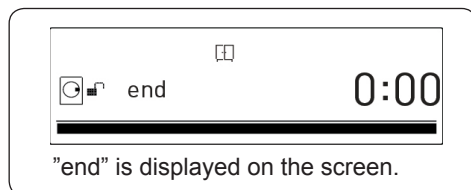

- You can open the machine's door and remove the laundry.
- Leave the door open for a short time to allow the interior of your machine to dry.
- Turn the programme dial to the CANCEL position.
- Unplug your machine.
- Turn the water faucet off.



If you are not satisfied with the drying level of your laundry, select the best drying programme for your laundry and dry your laundry again.



NOTE: Your machine has a stage that cools down your laundry at the end of its drying operation. This is to reduce the risk of you being harmed as you remove the laundry from your machine.

9.10. Child Lock

Your machine has a child lock so that the programme is not affected if the function buttons are pressed or the programme dial is turned while the machine is washing or drying.

Child lock engages after both of the  buttons next to the  symbol are pressed for more than 3 seconds.

The following warning text is displayed after the child lock is activated.

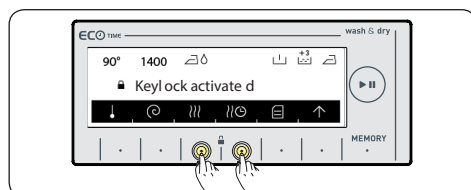

The following text will be displayed if any buttons are pressed while the child lock is

active.

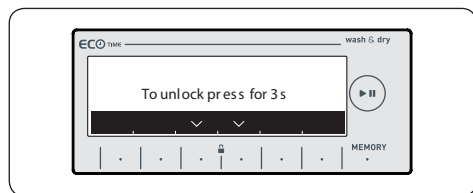

If the child lock is active and the programme dial is switched to STOP and another programme selected, the previously selected programme will continue from the point where it was stopped. No change will take place.

To deactivate the child lock, press the  buttons for more than 3 seconds. The following text will be displayed after the child lock disengages.

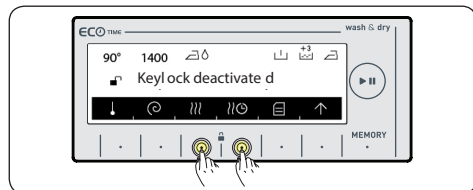

NOTE: Child lock does not lock the pump cover or detergent drawer of your machine.

10. PROGRAMME TABLE

Programme	WHITES/JEANS 90°	Cotton Eco	Eco 20°
Selectable washing temperatures (°C)	90, 80 ,70, 60, 50, 40, 30, * (Cold wash)*	* (Cold wash), 30°, 40°, 60°*	* (Cold water), 20°*
Maximum washing/drying capacity (kg)	10.0 / 6.0	10.0 / 6.0	4.0 / 4.0
Selectable spin speed (rev / min)	Ø (No spin), 400, 600, 800, 1000, 1200, 1400*	Ø (No spin), 400, 600, 800, 1000, 1200, 1400*	Ø (No spin), 400, 600, 800, 1000, 1200, 1400*
Laundry type / Descriptions	Heat resistant cotton and linen textiles (underwear, bedding, tablecloths and towels) (max 4.0 kg)	Cotton and linen textiles (underwear, bed sheet, tablecloth, towel (max. 4.0 kg)	Less dirty, cotton and linen textiles. (bed sheet, tablecloth, towel (max. 2.0 kg)
Selectable additional functions **			
Selectable drying functions **			

Programme	Synthetics	
	Synthetic***	Curtain***
Selectable washing temperatures (°C)	* (Cold wash), 30°, 40°, 60°*	* (Cold wash), 30°, 40°*
Maximum washing/drying capacity (kg)	3.5 / 3.5	2.5
Selectable spin speed (rev / min)	Ø (No spin), 400, 600, 800, 1000, 1200*	Ø (No spin), 400, 600*
Laundry type / Descriptions	Synthetic and synthetic mix textiles. (synthetic content shirt, blouse, socks etc.)	Wash your curtains only with this programme.
Selectable additional functions **		
Selectable drying functions **		-

NOTE: THE PROGRAMME DURATION MAY CHANGE ACCORDING TO THE AMOUNT OF LAUNDRY, TAP WATER, AMBIENT TEMPERATURE AND SELECTED ADDITIONAL FUNCTIONS.

(*) Programme factory default settings.

(**) When you want to select more than one additional function, the additional functions you wish to select may not comply with each other.

(***) These are sub-programmes. Refer to page 32 for programme selection.

Do not dry towels, cotton and linens, and synthetic and sythetic mix clothes together.
For drying select the most appropriate drying program for the clothes.

Programme	Delicates	
	Wool ***	Silk ***
Selectable washing temperatures (°C)	* (Cold wash), 30°, 40°*	* (Cold wash), 30°*
Maximum washing/drying capacity (kg)	2.5	2.5
Selectable spin speed (rev / min)	Ø (No spin), 400, 600*	Ø (No spin), 400, 600*
Laundry type / Descriptions	Woollen and wool mix laundry with machine wash labels.	Silk mixture laundry with machine wash labels.
Selectable additional functions **		
Selectable drying functions **	-	-

Programme	Duvet	Extras	
		Synthetics Wash & Dry***	Refresh***
Selectable washing temperatures (°C)	* (Cold wash), 30°, 40°*	* Cold wash), 30°, 40°*, 60°	-
Maximum washing/drying capacity (kg)	2.5	3.5	1.0
Selectable spin speed (rev / min)	Ø (No spin), 400, 600, 800*	600*	-
Laundry type / Descriptions	For washing a fibre duvet with a machine washable label. (max. 2.5 kg)	Synthetic and synthetic mix textiles. (synthetic content shirt, blouse, socks etc.)	This is not a washing programme. It simply breathes hot air into your laundry refreshing it.
Selectable additional functions **			
Selectable drying functions **	-		-

⚠ NOTE: THE PROGRAMME DURATION MAY CHANGE ACCORDING TO THE AMOUNT OF LAUNDRY, TAP WATER, AMBIENT TEMPERATURE AND SELECTED ADDITIONAL FUNCTIONS.

(*) Programme factory default settings.

(**) When you want to select more than one additional function, the additional functions you wish to select may not comply with each other.

(***) These are sub-programmes. Refer to page 32-33 for programme selection.

Do not dry towels, cotton and linens, and synthetic and sythetic mix clothes together.
For drying select the most appropriate drying program for the clothes.

Programme	Extras	
	Rinse ***	Spin***
Selectable washing temperatures (°C)	-	-
Maximum washing/drying capacity (kg)	10.0 / 6.0	10.0 / 6.0
Selectable spin speed (rev / min)	Ø (No spin), 400, 600, 800, 1000, 1200, 1400*	400, 600, 800, 1000, 1200, 1400*
Laundry type / Descriptions	This programme can be used for additional rinsing after washing.	This programme can be used for additional spinning after washing.
Selectable additional functions **		
Selectable drying functions **	30min 60min 120min	30min 60min 120min

Programme	Extras		Allergy Safe
	Drain ***	Drum clean ***	
Selectable washing temperatures (°C)	-	-	* (Cold wash), 30°, 40°, 50°, 60°
Maximum washing/drying capacity (kg)	-	-	5.0 / 5.0
Selectable spin speed (rev / min)	-	600*	400, 600, 800*
Laundry type / Descriptions	This programme is only used to drain your machine.	This is a drum cleaning programme and must be run without laundry.	Baby dresses
Selectable additional functions **	ECO TIME	ECO TIME	
Selectable drying functions **	-	-	30min 60min 120min









⚠ NOTE: THE PROGRAMME DURATION MAY CHANGE ACCORDING TO THE AMOUNT OF LAUNDRY, TAP WATER, AMBIENT TEMPERATURE AND SELECTED ADDITIONAL FUNCTIONS.





(*) Programme factory default settings.

(**) When you want to select more than one additional function, the additional functions you wish to select may not comply with each other.

(***) These are sub-programmes. Refer to page 33 for programme selection.

Do not dry towels, cotton and linens, and synthetic and sythetic mix clothes together.
For drying select the most appropriate drying program for the clothes.

Programme	Rapid	
	SUPERJET 30°/12'	DAILY 60°/60'
Selectable washing temperatures (°C)	* (Cold wash), 30°*	-* (Cold wash), 30°, 40°, 50°, 60°*
Maximum washing/drying capacity (kg)	2.0 / 2.0	5.0 / 5.0
Selectable spin speed (rev / min)	Ø (No spin), 400, 600, 800*	Ø (No spin), 400, 600, 800, 1000, 1200 1400*
Laundry type / Descriptions	For washing less dirty cotton, coloured and linen textiles in a little as 12 minutes. Note: As the washing time is short, less detergent is required than in other programmes. The programme period will increase if your machine detects unstable loading.	Dirty, cotton, coloured and linen textiles. (The washing duration for loads of 2kg and under is 30 minutes)
Selectable additional functions **	Ø   ECO TIME	Ø   ECO TIME
Selectable drying functions **	Ø   30min 60min 120min	Ø   30min 60min 120min

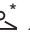
Programme	Dry	
	DELICATE DRY	COTTON DRY
Selectable washing temperatures (°C)	-	-
Maximum washing/drying capacity (kg)	3.5	7.0
Selectable spin speed (rev / min)	-	-
Laundry type / Descriptions	Cotton laundry with machine dryable label.	Cotton laundry with machine dryable label.
Selectable additional functions **	 ECO TIME	 ECO TIME
Selectable drying functions **	  30min 60min 120min	  30min 60min 120min







NOTE: THE PROGRAMME DURATION MAY CHANGE ACCORDING TO THE AMOUNT OF LAUNDRY, TAP WATER, AMBIENT TEMPERATURE AND SELECTED ADDITIONAL FUNCTIONS.

(*) Programme factory default settings.

(**) When you want to select more than one additional function, the additional functions you wish to select may not comply with each other.

Do not dry towels, cotton and linens, and synthetic and sythetic mix clothes together.
For drying select the most appropriate drying program for the clothes.

Programme	Wash & Dry	
	JET WASH & DRY	COTTON WASH & DRY
Selectable washing temperatures (°C)	* (Cold wash), 30°*	* (Cold wash), 30°, 40°, 50°, 60°, 70°, 80°, 90°
Maximum washing/drying capacity (kg)	0.5 kg (3 shirts) (29 minutes) 1.5 kg (9 shirts) (60 minutes)	6.0
Selectable spin speed (rev / min)	800*	1400*
Laundry type / Descriptions	Cotton, coloured and linen laundry with machine dryable label. Note: The machine automatically determines the duration of the programme according to the amount of laundry in the machine.	Cotton and linen textiles (underwear, bed sheets, tablecloth, towel (max. 4.0 kg)
Selectable additional functions **	 ECO TIME	 ECO TIME
Selectable drying functions **		 30min 60min 120min

 **NOTE:** THE PROGRAMME DURATION MAY CHANGE ACCORDING TO THE AMOUNT OF LAUNDRY, TAP WATER, AMBIENT TEMPERATURE AND SELECTED ADDITIONAL FUNCTIONS.

(*) Programme factory default settings.

(**) When you want to select more than one additional function, the additional functions you wish to select may not comply with each other.

Do not dry towels, cotton and linens, and synthetic and sythetic mix clothes together.
For drying select the most appropriate drying program for the clothes.

11. SELECTING SUB-PROGRAMMES

11.1. Synthetics

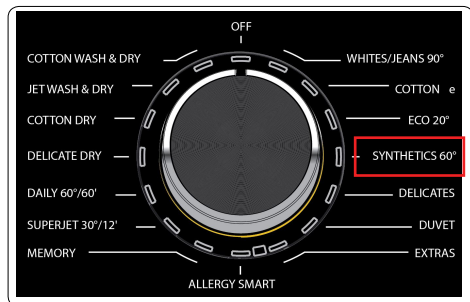

When you select the Synthetics programme, you will have two sub-programme options to choose from:

1. Synthetics
 2. Curtain
- Select the required sub-programme selections by pressing the <> buttons.

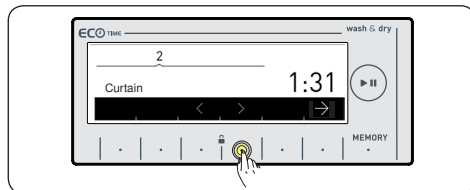
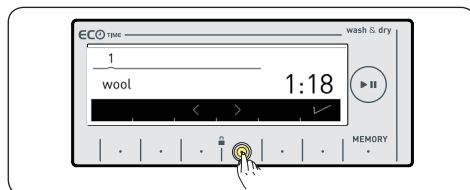

- Activate the selected sub-programme by pressing the → button.

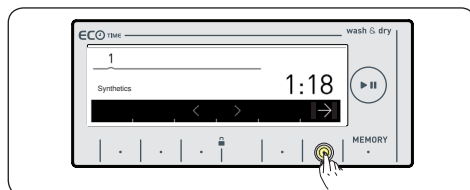

- After your selection has been activated the information screen will return to the main programme screen. You can

select any other required programme features or functions using the available information screen buttons. Press the Start/Pause button to run the selected programme.

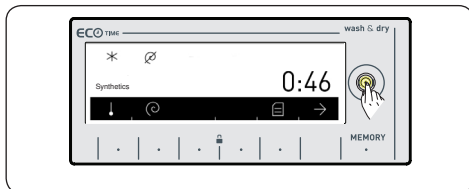

11.2. Delicates

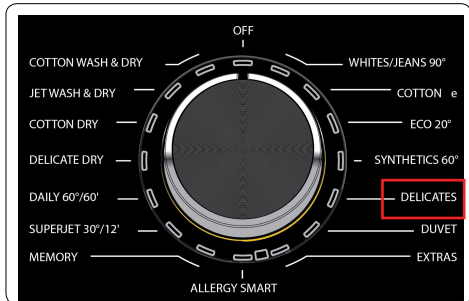

When you select the Delicates programme, you will have two sub-programme options to choose from:

1. Wool
 2. Silk
- Select the required sub-programme selections by pressing the <> buttons.

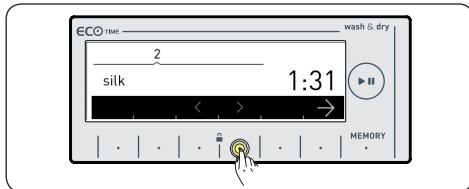
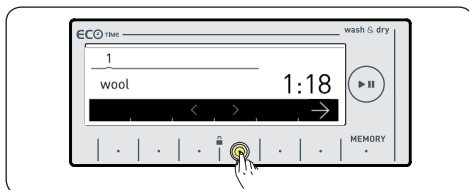

- Activate the selected sub-programme by pressing the → button.

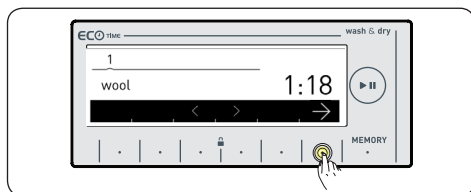

- After your selection has been activated, the information screen will return to the main programme screen. You can select any other required programme features or functions using the available information screen buttons. Press the Start/Pause button to run the selected programme.

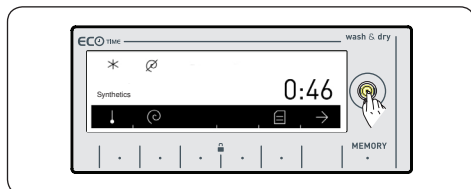

11.3. Extras

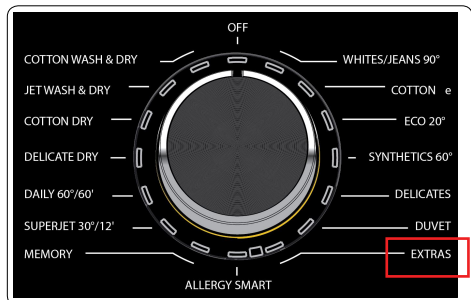

When you select the Extras programme, you will have six sub-programme options to choose from:

- Refresh
 - Rinse
 - Spin
 - Drain
 - Drum clean
 - Synthetics Wash & Dry
- Select the required sub-programme selections by pressing the < > buttons.

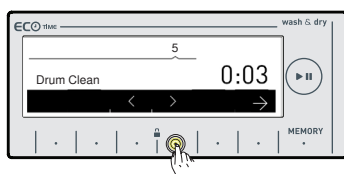
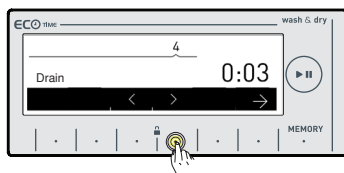
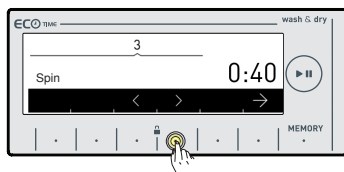
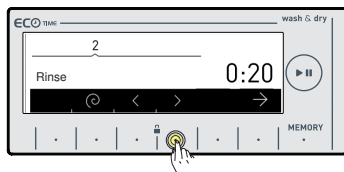
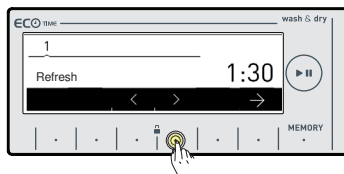

- Activate the selected sub-programme by pressing the → button.
- After your selection has been activated the information screen will return to the main programme screen. You can select any other required programme features or functions using the available information screen buttons. Press the Start/Pause button to run the selected programme.

12. MAINTENANCE AND CLEANING OF YOUR MACHINE

12.1. Warning

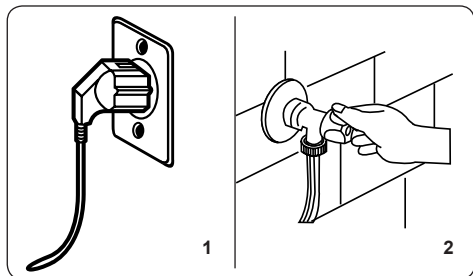

Turn your mains power supply off and remove the plug from the socket before carrying out maintenance and cleaning your machine.

Turn off the cold water supply before starting maintenance and cleaning your machine.

⚠ CAUTION: Do not use solvents, abrasive cleaners, glass cleaners or all-purpose cleaning agents to clean your Washer Dryer. They may damage the plastic surfaces and other components with the chemicals they contain.

12.2. Water Inlet Filters

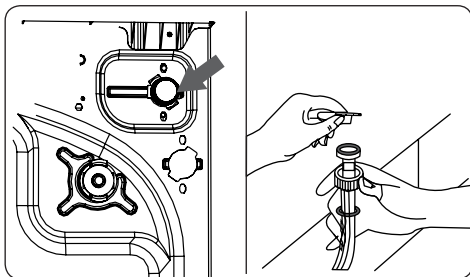

Water inlet filters prevent dirt and foreign materials from entering your machine. It is recommended that these filters are cleaned when your machine is unable to receive sufficient water, although your water supply is on and the tap is open. We recommend that you clean your water inlet filters every 2 months.

- Unscrew the water inlet hose from the Washer Dryer.
- To remove the water inlet filter from the water inlet valve, use a pair of long-nosed pliers to gently pull on the plastic bar in the filter.
- A second water inlet filter is located in the tap end of the water inlet hose. To remove the second water inlet filter, use a pair of long-nosed pliers to gently pull on the plastic bar in the filter.
- Clean the filter thoroughly with a soft brush and wash with soapy water and rinse thoroughly. Re-insert the filter by gently pushing it back into place.

⚠ CAUTION: The water inlet filters can become clogged due to water quality or lack of required maintenance and may break down. This may cause a water leak. Any such breakdowns are out of the scope of the warranty.

12.3. Detergent Drawer

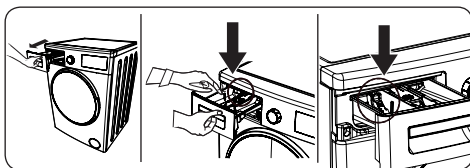

The use of detergent may cause residual build up in the detergent drawer over time. We recommend that you remove the drawer every 2 months to clean the

accumulated residue.

To remove the detergent drawer:

- Pull the drawer forwards until it is fully extended.
- Gently press down on the detergent drawer (as shown above) and pull the drawer from its housing.
- Clean the drawer with water and a soft brush.
- If there is any residue in the drawer housing, remove with a soft brush. Take care to prevent any residue from dropping into the machine.
- Dry the drawer thoroughly and slide it back into the housing.

 **Do not wash your detergent drawer in dishwasher.**

12.4. Pump Filter

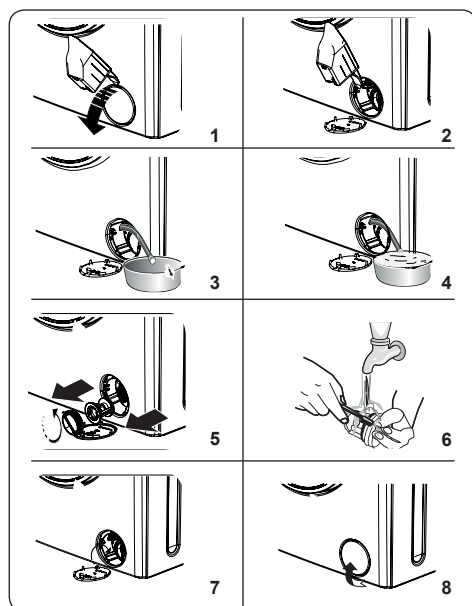

The pump filter system in your Washer Dryer prolongs the life of the pump by preventing lint from entering your machine. We recommend that you clean the pump filter every 2 months.

The pump filter is located behind the cover on the front-lower right corner.

To clean the pump filter:

1. You may use the washing powder spade

(*) supplied with your machine or liquid detergent level plate to open the pump cover.

2. Lodge the end of the powder spade or liquid detergent level plate in the opening of the cover and gently press backwards. The cover will open.
3. Pull the black rubber hose forward and detach it from its clamp, place a container under it and remove the plug from the hose.
4. Collect the water drained from your machine in a container.

 **NOTE:** Depending on the amount of water inside the machine, you may have to empty the water collection container a few times.

- Once the water has fully drained, fit the plug back on the hose.
 - Fit the hose back into the clamp.
5. Loosen the filter cover by turning it anti-clockwise and remove by pulling.
 6. Remove any foreign materials from the filter with a soft brush.
 7. After cleaning the filter, replace the filter cover and tighten by turning clockwise.
 - Please note that the filter cover may leak water unless re-fitted properly.
 8. Close the filter cover.
 - When closing the pump cover, ensure that the mountings inside the cover meet the holes on the front panel of the machine.

13. FLUSH STOPPER / BODY / DRUM

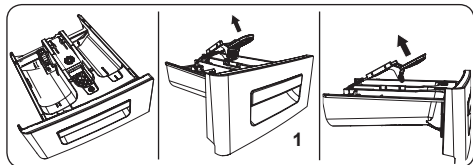

1. Flush stopper

Remove the detergent drawer and disassemble the flush stopper. Clean thoroughly to completely remove any softener residue. Refit the flush stopper after cleaning and check that it is seated properly.

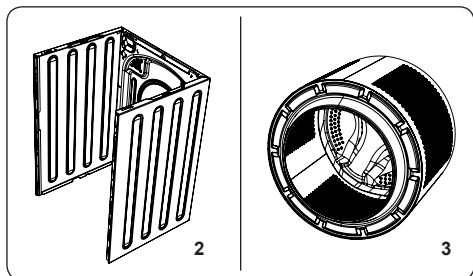

2. Body

Use a mild, non-abrasive cleaning agent, or soap and water, to clean the external casing. Wipe dry with a soft cloth.

3. Drum



Do not leave metallic objects such as needles, paper clips, coins etc. in your machine. These objects lead to the formation of rust stains in the drum. To clean such rust stains, use a non-chlorine cleaning agent and follow the instructions of manufacturer of the cleaning agent. Never use wire wool or similar hard objects for cleaning rust stains.

14. TROUBLESHOOTING

Repair of your machine should be carried out by an authorised service company. If your machine requires repair or if you cannot solve an issue with the information provided below, then you should:









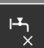

- Unplug your machine from the mains power supply.
- Turn off the water supply.
- Contact the nearest authorised service company.

FAULT	POSSIBLE CAUSE	TROUBLESHOOTING
Your machine will not start.	It is not plugged in.	Insert the plug into the socket.
	The fuse is faulty.	Replace the fuse.
	Mains supply is cut off.	Check the mains supply.
	Start/Pause button is not pressed.	Press the Start/Pause button.
	The programme dial is in the Stop (off) position.	Turn the program dial to the desired position.
	The door of your machine is not closed properly.	Close the door of your machine.
Your machine does not discharge	Drain hose is clogged or twisted.	Check the drain hose.
	Pump filter clogged.	Clean the pump filter.
Your machine vibrates.	The feet have not been adjusted.	Adjust the feet.
	Transit bolts have not been removed.	Remove the transit bolts from your machine
	Your machine only has a small amount of laundry inside.	This will not prevent the operation of your machine.
	Your machine is overloaded with laundry or the laundry is not distributed evenly.	Do not overload your machine. Make sure the laundry is spread out.
	Your machine is located on a hard surface.	Avoid installing your machine on a hard surface. When installing your machine, leave a 2 cm gap between walls or hard surfaces.
Excessive foam is formed in the detergent drawer.	Too much detergent has been used	Press the Start/Pause button. To stop the foam, dilute one tablespoon of softener into 1/2 litre of water and pour into the detergent drawer. Press the Start/Pause button after 5-10 mins
	Wrong detergent used.	Use detergents produced only for automatic washing machines in your machine.
Unsatisfactory washing result.	The laundry is too dirty for the programme you have selected.	Select programmes appropriate for your laundry's level of dirtiness. (See page 27-31 programme table)
	Not enough detergent used.	Use the amount of detergent as instructed on the packaging
	There is too much laundry in your machine.	Check that the maximum capacity of your Washer Dryer is not exceeded.
As soon as the machine is loaded with water, water discharges.	The end of the water drain hose is too low for the machine.	Set the water drain hose to an appropriate height.
No water appears in the drum during washing.	No fault. Water is in the unseen part of the drum.	-

FAULT	POSSIBLE CAUSE	TROUBLESHOOTING
There is detergent residue on your laundry after washing	Non-dissolving particles of some detergents may appear on your laundry as white spots.	Perform an extra rinse, or clean your laundry with a brush after it dries
There is detergent residue on your laundry after washing	There is untreated oil, cream or laundry	Use the amount of detergent as instructed on the packaging in the next wash
Spinning operation is not performed or runs late.	No fault. Unbalanced load control system has been activated.	<p>The unbalanced load control system will try to spread your laundry evenly. The spinning operation will begin once your laundry is evenly spread.</p> <p>Place the laundry in the machine in a balanced fashion next time.</p>
The load detection system on the screen does not work while loading the machine.	Laundry is placed into the machine without choosing a washing or drying programme.	Remove the laundry in your machine. Switch the programme dial to Off position, reselect the programme you want to select. Load the laundry in the machine and run.
Symbol is  displayed on screen and machine does not run.	There is more laundry in the machine than the maximum laundry amount for the washing or drying programme you selected.	 Remove laundry from your machine until the symbol disappears
Laundry remains damp after the drying operation.	Appropriate drying programme is not selected. The maximum load capacity for the selected programme might be exceeded.	Select a drying programme appropriate for your laundry (see page 27-31 for the programme table)

15. AUTOMATIC FAULT WARNINGS AND WHAT NEEDS TO BE DONE

Your machine is equipped with a built-in fault detection system, which is able to offer guidance should your machine not operate as expected.

TROUBLE CODE	POSSIBLE FAULT	WHAT TO DO
 Check the door	The door of your machine is left open.	Close the machine door. If the error code is still displayed turn off your machine, unplug it and contact the nearest authorised service company immediately.
 NO WATER Check water supply. 	<p>The water tap is off, mains water pressure may be low or the mains water may be cut off.</p> <p>The water inlet hose may be twisted, kinked or clogged.</p>	<p>- If water is not reaching the machine, turn the programme dial to the CANCEL position. You can select a programme and run your machine after the water supply is restored.</p> <p>- Clean and re-fit the water inlet hose and valve inlet filters.(*)</p> <p>If the problem persists, unplug your machine, turn off your tap and contact the nearest authorised service company.</p>
 PUMP Unplug the machine. 	The pump may be damaged, pump filter may be clogged or pump electrical connection is malfunctioning.	Clean the pump(**)filter. If the problem persists, contact the nearest authorised service company.
 FILTER Check filter. 	The pump is damaged, the pump filter is clogged or the electrical connection to the pump is malfunctioning.	<p>- The pump filter may be clogged.</p> <p>- Clean the pump filter. (**)</p> <p>- Drain hose may be clogged or twisted.</p> <p>- Check the Drain hose.</p> <p>- If the problem persists, contact the nearest authorised service company.</p>
 OVERFLOW Close tap. 	Your machine has an excessive amount of water.	<p>Your machine will drain water by itself.</p> <p>If the problem persists, turn off your machine and unplug it. Turn off your faucet and contact the nearest authorised service company.</p>
 VOLTAGE Out of range. 	Mains voltage is high or low.	<p>Check if the socket you have your machine plugged into is grounded.</p> <p>Have an electrician measure the amount of voltage coming to your house.</p> <p>If there is no problem in the electricity supply, unplug your machine and inform the nearest service company.</p>

16. DESCRIBING THE ENERGY LABEL AND SAVING ENERGY

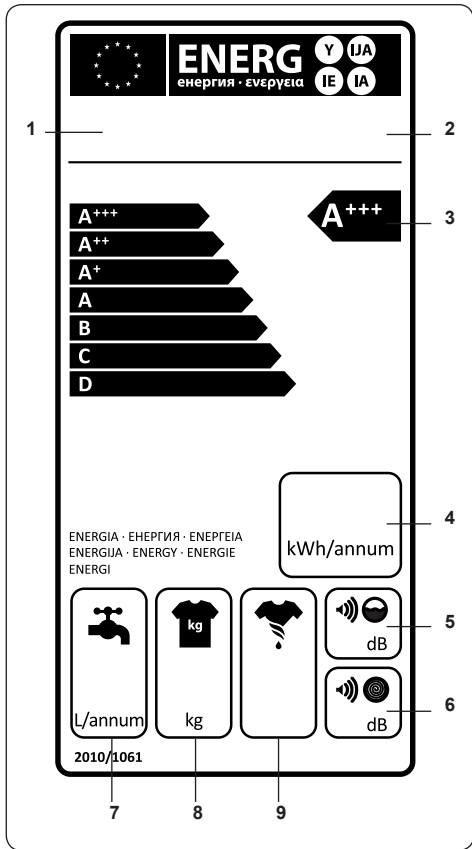

1. Brand
2. Model
3. Energy Class
4. Energy Consumption
5. Noise Value While Washing
6. Noise Value While Spinning
7. Annual Water Consumption
8. Dry Laundry Capacity
9. Spinning Performance

Energy and water consumption may vary based on water pressure, water hardness, water temperature, ambient temperature, amount of laundry, additional function selection and/or voltage fluctuations.

To reduce energy and water consumption, do not exceed the maximum laundry amounts for the selected programme, wash your laundry when it is lightly soiled or wash

your daily laundry in short programmes. Make sure you clean your machine and perform maintenance periodically and use your machine at lower-cost times as specified by your electricity vendor.



Service
& Support

Visit our website:

www.sharphomeappliances.com

Or contact us:



You **Tube**